

REVISED PLAN

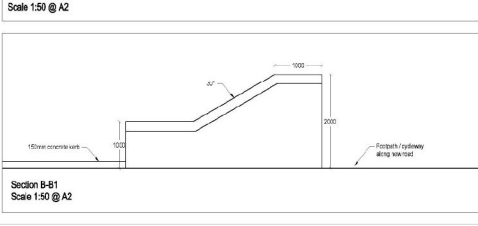
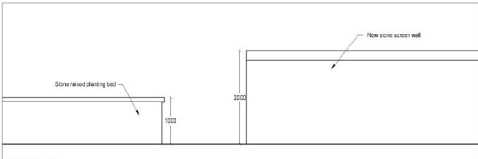
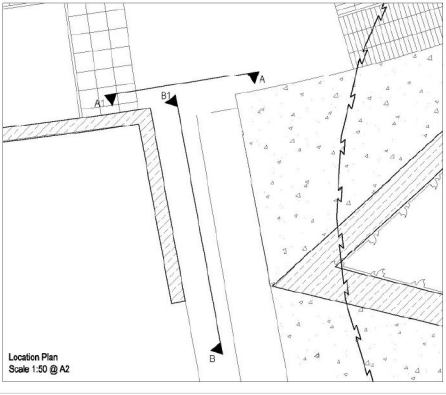
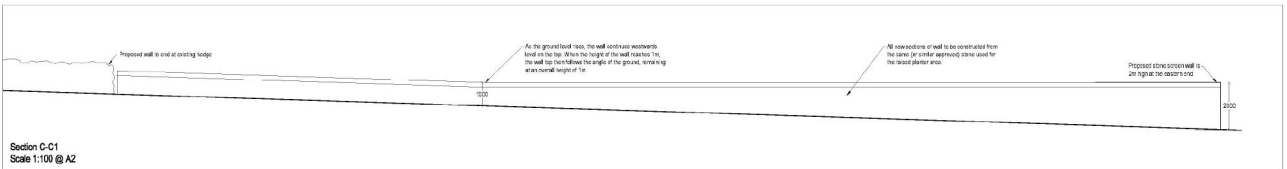
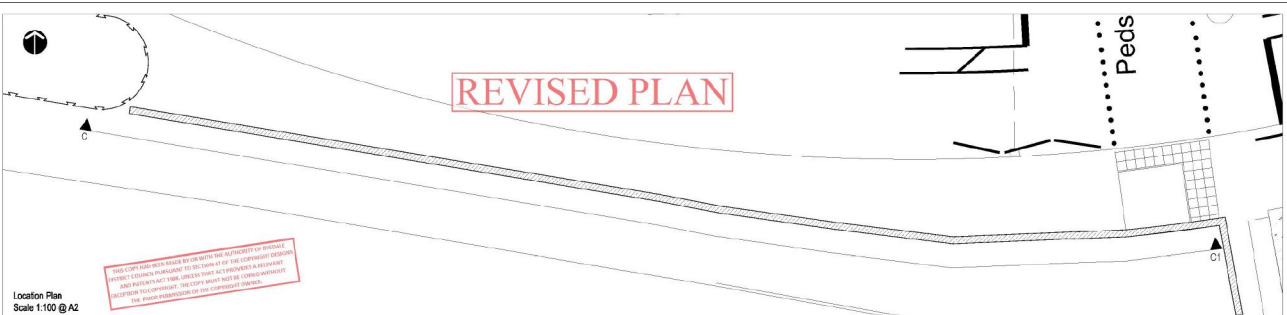

This drawing is the copyright of Rosetta Landscape Design and cannot be reproduced in any form without the express consent of the company. Written and scaled dimensions to be checked on site, any discrepancies reported prior to work commencing. If in doubt please ask.

This drawing has been prepared for the purpose of planning approval.

- Rev D: Revised to show long section of wall - 01/Mar/16 (EP)
 - Rev C: Revised to show new planter alignment - 15/Feb/16 (EP)
 - Rev B: Revised to show shallower angle on wall as requested by council - 16/Apr/16 (EP)
 - Rev A: Revised to show alternative wall finish - 11/Dec/15 (MP/tp)
- Base: PRA Architects, Proposed Site Layout, Y9181703 received 06/Jun/11

PROJECT	Outgard Road, Manton
TITLE	Wall Elevations
CLIENT	Taylor Wimpey, North Yorkshire
DATE	24 Oct 12 SCALE VARIES SHEET A2
DRAWN	MP/tp DRAWING NO 2202/23
CHECKED	- REVISION D

ROSETTA
LANDSCAPE ARCHITECTS

Chartered Landscape Architects

115a Clufl Rosetta Way
York YO2 5BA
Telephone +44 (0)1904 754276
Facsimile +44 (0)1904 709552
Email: info@rosetta-landscape.co.uk
Web: www.rosetta-landscape.co.uk

DATE
02.09.16

REVISED PLAN

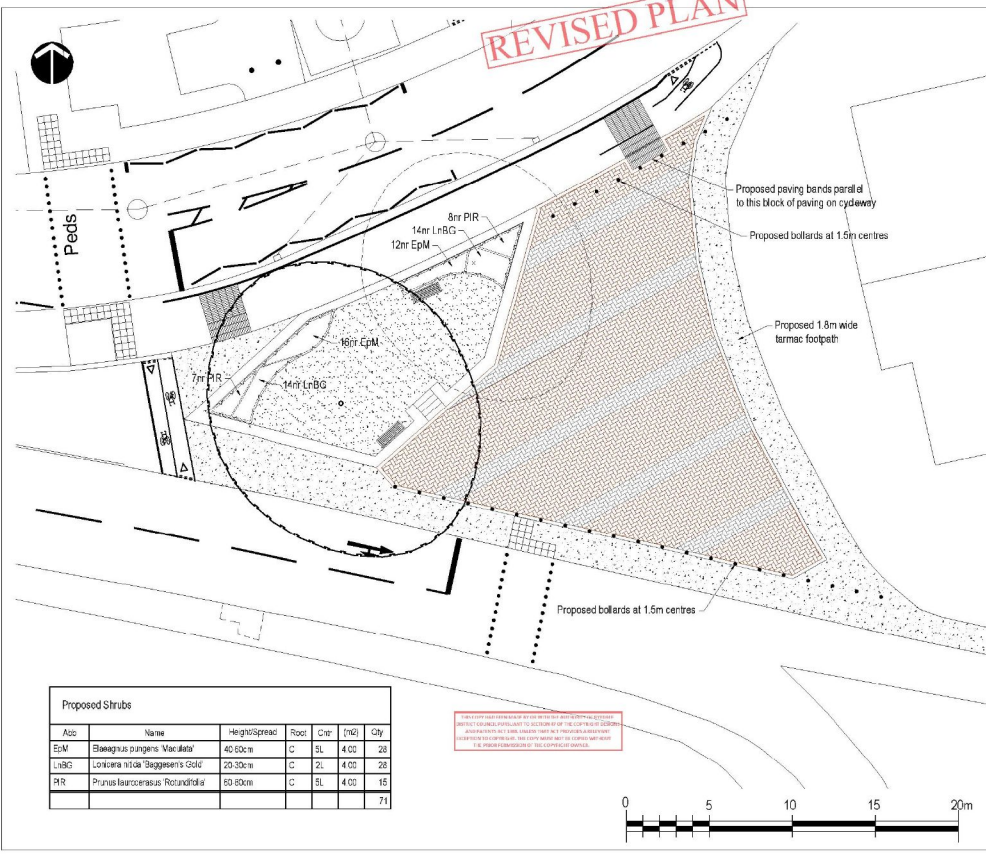

Proposed Shrubs						
Acc	Name	Height/Spread	Root	Chr	(%G)	Qty
EpM	Blauwgras pungens 'Maculata'	40/50cm	C	SL	4.00	28
LnBG	Lonicera nitida 'Baggesen's Gold'	20/30cm	C	2L	4.00	28
PIR	Prunus laurocerasus 'Rotundifolia'	60/80cm	C	SL	4.00	15
						71

PLEASE NOTE: ALL PLANTING SHALL BE INSTALLED IN ACCORDANCE WITH THE LATEST VERSIONS OF THE BRITISH STANDARD BS 5832:2007 AND BS 5832:2009. ALL PLANTING SHALL BE INSTALLED IN ACCORDANCE WITH THE LATEST VERSIONS OF THE BRITISH STANDARD BS 5832:2007 AND BS 5832:2009. ALL PLANTING SHALL BE INSTALLED IN ACCORDANCE WITH THE LATEST VERSIONS OF THE BRITISH STANDARD BS 5832:2007 AND BS 5832:2009.

This drawing is the copyright of Rosetta Landscape Design and cannot be reproduced in any form without the express consent of the company. Written and scaled dimensions to be checked on site. Any discrepancies reported prior to work commencing. If in doubt please ask.

Planting Notes
 Topsoil: The topsoil shall be a minimum of 100mm depth over existing beds and graded to fall. Imported topsoil must be BS5832:2007 compliant and existing topsoil must be cultivated in accordance with BS5832:2007. No fertilisers should be used in well waterlogged conditions.
 Herbicide and cutback: Topsoil to be treated with herbicide prior to planting, where necessary, strictly in accordance with the Control of Pesticides Regulations 1986 (as amended 1997) or otherwise as indicated on the label and the manufacturer's instructions to be quoted with the topsoil shall be cultivated to 150mm depth.
 Planting: All planting and bedding shall conform to BS 5830: 1992 and BS 4428: 1988.
 Container grown shrubs, transplants and whips: Shrubs and transplants shall be planted in pits 50x30x30 (where applicable) and the rootball shall include 3 lines of root ball tree and shrub compost. When two or more shrub species are indicated in a single bed each species shall be normally spaced throughout the bed in groups of 3's.
 Herbicide: Spot treat with herbicide throughout the maintenance period in accordance with the manufacturer's instructions.
 Masts: Planting beds to receive 75mm deep protected ornamental mast masts. Mast headwindings shall to be painted with 50g flat matt paint per litre. Mast headings to be painted with 50g flat matt paint per litre. Mast headings to be painted with 50g flat matt paint per litre. Mast headings to be painted with 50g flat matt paint per litre.
 Plant position: Final position of trees and shrubs subject to confirmation of service location and approval of statutory authorities.
 Grass: All turf-laid areas to be cultivated and levelled as required removing any stones, roots, subsoil, general construction waste.
 Planting Season: Tree and shrub planting to be carried between mid-November and mid-March dependent upon the planting season.

LEGEND

- Existing tree to be retained
- Existing tree to be removed
- Existing grass area not to be reseeded where necessary
- Proposed shrub bed
- Proposed border with back rest (position to be agreed)
- Proposed 4m wide beds of Marshall's Kynoch Seving (Bromus) under a tarmac surface (200x1000) www.marshall.co.uk
- Proposed 1m wide beds of Marshall's Kynoch Seving (Chorizan) laid in a tarmac surface (200x1000) www.marshall.co.uk
- Proposed 4m wide beds of Marshall's Kynoch Seving (Chorizan) laid in a tarmac surface (200x1000) www.marshall.co.uk
- Proposed tarmac surface
- Proposed Marshall's Trees (S) 500 Standard Steel Bollard per similar approval www.marshall.co.uk

Rev G: Revised to council comments - 01Mar16 (BP)
 Rev F: Revised to show new parking alignment - 18Nov15 (BP)
 Rev E: Revised to show site visit and amended layout - 03Dec15 (BP/PP)
 Rev D: Revised to show new company details - 28Nov14 (BP)
 Rev C: Revised to Local Authority comments received 23Oct12 - 24Oct12 (NS)
 Rev B: Revised to Local Authority comments received 16Nov11 - 06Dec12 (NS/)
 Rev A: For scale added & drawing scale corrected - 13Oct11 (NS/)
 Base: PIR: Archibutea, Proposed Site Layout, Y81 S11753 received 16Jan11

PROJECT Outground Road, Walton
TITLE POS Detailed Landscape Proposals
CLIENT Taylor Wimpey, North Yorkshire
DATE 24 Oct 12 **SCALE** 1:200 **SHEET** A3
DRAWN NS **DRAWING NO** 220218
CHECKED - **REVISION** G

ROSETTA
 Rosetta Landscape Architects
 15th Oct 12 10:55 AM
 York YO2 2SA
 Telephone: +44 (0)1904 714120
 Fax: +44 (0)1904 714120
 Email: info@rosetta.co.uk
 Web: www.rosetta.co.uk

DATE 02/03/16